

Because life is

Petty<sup>TM</sup>  
Real

3 The Bullion  
Barley  
BB12 9JX



For Sale  
£300,000

3 1 2 D

GROUND FLOOR  
50.1 sq.m. (539 sq.ft.) approx.

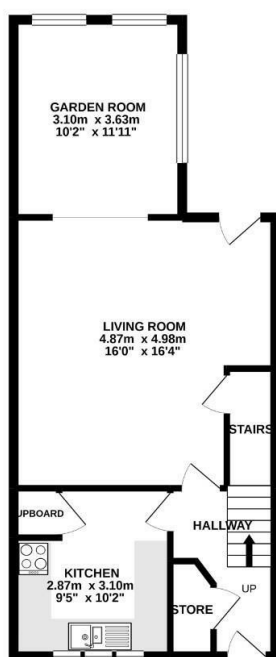

1ST FLOOR  
38.8 sq.m. (418 sq.ft.) approx.

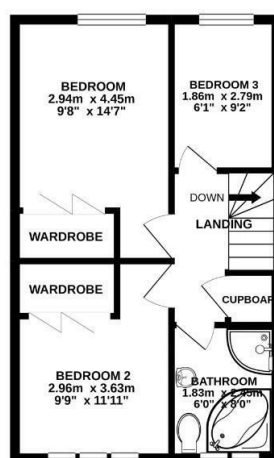

TOTAL FLOOR AREA: 88.9 sq.m. (957 sq.ft.) approx.

Whilst every attempt has been made to ensure the accuracy of the floorplan contained herein, measurements of doors, windows, rooms and any other items are approximate and no responsibility is taken for any error, omission or misstatement. This plan is for illustrative purposes only and should be used as such by any prospective purchaser. The services, systems and appliances shown have not been tested and no guarantee as to their capability or efficiency can be given.  
Made with Floorplan Studio



These particulars, whilst believed to be accurate are set out as a general outline only for guidance and do not constitute any part of an offer or contract. Intending purchasers should not rely on them as statements of representation of fact, but must satisfy themselves by inspection or otherwise as to their accuracy. No person in this firm's employment has the authority to make or give any representation or warranty in respect of the property.

134 Gisburn Road, Barrowford, Lancashire, BB9 6HQ  
T. 01282 615900  
Barrowford.sales@pettyreal.co.uk

[www.pettyreal.co.uk](http://www.pettyreal.co.uk)